

BC H9G

%F9H9BHC B: C F7 9-B 6C8MHC 69%#& @A B"  
&"C DHC B5@DC @FNB; ?9MBC H5J J5-@6@  
...CB !&\$5B8 !& DC GHC BG'  
... 7 F9DF 9GBHG'5 7F +7 5@8A 9BG B: C F  
GH5HG7 5@DFC 7 9GG7 C BHC @

fH7 G8!LL!\$%L!B`G<C K Bt

H7 G8!LL!LL!L!L!LLL

Bc'C:DCGHC BGZD9F'FC K  
!\$&'HkFI'!&)  
@958'GHM@9  
!\$%T G9'7!) +!L

```
C DHC B
!D'LL".DC @5F #98 'A 5HB;
fl G9'D?;$+!B'Z'G99: ÷ "'%L
!GF.'GH'5-B'F'9@9.
fG99': ÷ "' L
```

C DHC B  
!B. fG99 BC H? &L  
.....I G9H 6!LL!8!Dz @5J 9'6@5B? : CF  
.....G5B85F8 5B8 I G9H 6!LL!8L

D5 7 ? 5 ; 9 D 5 F H G B H 6 9 5 G G < C K B

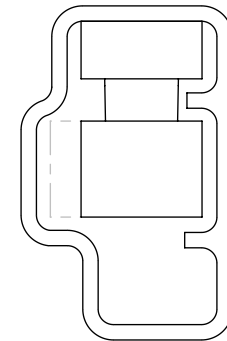

D5775; B; B C H G  
%D5FHG 69DC G H C B 98 B H 69  
...K H %DC G H C B G5A 98F 97 H C B  
...5G5FFC C "  
&"I G9DH%&(!\$% " 5B8 f&LH!\$ "

0 : ÷ "'  
 fH7 G8!LL!LL!L!LGFŁ  
 fG5A 9'5G: ÷ "'&ž8 ÷: 9F9BH5G'G<CK BŁ

fBc"C: `DC G'l "'\$+, +( Q"\$\$\$\$QZ'"" %\$\$\$Q+", +( \$QF 9:

H 6!LL!8!GF —

```

: ÷ "%
!D'LL".DC @F#P8'A 5HB;
LL1'DC G#C B'BC"
B G9FHDC @F#B; ?9MD5FH
BC"D?;$+!B'BHC GD97 ÷ 98'
DC G#C B'LL"

```

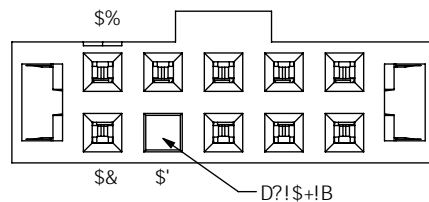

```

IB @GG CH 9FK 69 GD97 ÷ 98Z
8A 9BG€ BG5F9-B B7 < 9G"
HC @F5B7 9G 5F9.
897 A 5@.....5B; @G
"LL. ±$%Q' Q" &°
"LLL. ±$$) '0% Q
"LLLL. ±$$$ $ $) %Q

```

D F C D F 9 5 F M B C H 9  
8 C 7 1 A 9 B H 7 C B H 5 B G B : C F A 5 H C B  
8 : 8 9 H 5 @ 5 B 8 D F C D F 9 5 F M H C  
H 7 2 8 7 \* 5 B 8 G : 5 @ B C H 6 9 F 9 D C 8 1 7 9 8  
H 5 B G 9 F 9 H C : C H 9 8 C 7 1 A 9 B H G C F  
\* C 9 8 H C : C H : 9 F G C F 1 G 9 8 : C F 5 B M  
D C G 9 C H 9 F H : 5 B H : 5 H K < 7 < H K 5 G  
5 : B 8 H C : H C 1 H H : 9 9 L D F 9 C 9 8 H C F H 4 9 B  
C 9 8 H C : G F A H 7 2 8 7 \*

A5HF5@ 8C`BCHG75@9`8F5K`B;  
BG @HC F.6@7?`D6H  
7C B H57H<95HF 95H98`6Y7i

G<99HG7 5 @9. (.%

8 9G7 F ~~DH~~€ B.

8K ; "BC"

**samtec**

)&\$D5F? 95GH6@ 8zB9K 5@5BM:B (+) \$  
D<C B9, %&- (!\*+' .....: 5L, %&- (!) \$(+  
Y!A U]. bZ: 4 G5A H97 "Wc a ..... WcXY.)' &&

&A A : 9A 5@9=87 '5 GG9A 6@M

H7 G8!LL!LL!L!L!LLL

6M	6F5M	%/#% #&\$ \$+	G<99H% C: %
----	------	---------------	-------------

∴.P8K : PA €7 PA ?H PH7 G8!LL!LL!L!LL!A ?HG@88FK