



Self-insulated with high dielectric-strength nylon sleeves, these ring terminals are recommended for temperatures up to 105°C. An inner bronze insulation grip sleeve lengthens the flexing radius of the conductor and eliminates conductor creep. The nylon jacket is color-coded:

Color Code	Wire Range
yellow	26-22
red	22-16
blue	18-14
yellow	12-10

Most standard bulk catalog numbers can be put on Mylar Tape for reel fed applications (i.e. 12050 tool and application dies). See pages 190-191.

Please put the suffix M for Mylar Tape RA2573M.

(Bulk number 1000 and 500 packages.)

RZ & RAX stock thickness: .02  
 RA & RB stock thickness: .03  
 RC stock thickness: .04

### Nylon Insulated Ring – Insulation Grip

Cat. No.	Pkg. Qty.	Wire Range	Max. Ins.	Bolt Hole	Wt./Lbs. Per 1000	Dimensions			
						A	B	C	M
RZ22-2**	100	26-22	.083	#2	1	.57	.14	.13	.49
RZ22-4**	100	26-22	.083	#4	1	.65	.21	.20	.54
RZ22-6**	100	26-22	.083	#6	1	.65	.21	.20	.54
RZ22-8**	100	26-22	.083	#8	1	.75	.25	.23	.62
RZ22-10**	100	26-22	.083	#10	1	.75	.25	.23	.62
RAX23*	1000	26-24	.125	#2	3	.66	.14	.14	.59
RAX43*	1000	26-24	.125	#4	3	.74	.20	.19	.64
RAX63*	1000	26-24	.125	#6	3	.84	.25	.22	.72
RAX83*	1000	26-24	.125	#8	3	.84	.25	.22	.72
RAX103*	1000	26-24	.125	#10	3	.84	.25	.24	.72
RA18-4	100	22-16	.136	#4	2	.70	.23	.14	.59
RA323	1000	22-16	.136	#4	2	.70	.23	.14	.59
RA333	1000	22-16	.136	#6	2	.70	.23	.14	.59
RA18-6	100	22-16	.136	#6	2	.83	.26	.25	.71
RA853	1000	22-16	.136	#6	2	.83	.26	.25	.71
RA18-8	100	22-16	.136	#8	3	.83	.26	.25	.71
RA833	1000	22-16	.136	#8	3	.83	.26	.25	.71
RA863	1000	22-16	.136	#8	3	.83	.26	.25	.71
RA18-10	100	22-16	.136	#10	2	.86	.31	.25	.71
RA873	1000	22-16	.136	#10	2	.86	.31	.25	.71
RA18-14	100	22-16	.136	1/4"	3	1.07	.46	.31	.84
RA713	1000	22-16	.136	1/4"	3	1.07	.46	.31	.84
RA18-516	100	22-16	.136	5/16"	3	1.07	.46	.31	.84
RA723	1000	22-16	.136	5/16"	3	1.07	.46	.31	.84
RA18-38	100	22-16	.136	3/8"	3	1.17	.53	.35	.87
RA733	1000	22-16	.136	3/8"	3	1.17	.53	.35	.87
RA18-12	100	22-16	.136	1/2"	3	1.27	.72	.50	.92
RA753	1000	22-16	.136	1/2"	3	1.27	.72	.50	.92
RB14-4	100	18-14	.162	#4	2-1/2	.72	.26	.14	.59
RB1323	1000	18-14	.162	#4	2-1/2	.72	.26	.14	.59
RB14-6	100	18-14	.162	#6	3	.89	.31	.25	.71
RB853	1000	18-14	.162	#6	3	.89	.31	.25	.71
RB1333	1000	18-14	.162	#6	3	.74	.26	.14	.59
RB14-8	100	18-14	.162	#8	3	.89	.31	.25	.71
RB863	1000	18-14	.162	#8	3	.89	.31	.25	.71
RB14-10	100	18-14	.162	#10	3-1/2	.89	.31	.25	.71
RB873	1000	18-14	.162	#10	3-1/2	.89	.31	.25	.71
RB14-14	100	18-14	.162	1/4"	3-1/2	1.08	.47	.31	.81
RB713	1000	18-14	.162	1/4"	3-1/2	1.08	.47	.31	.81
RB14-516	100	18-14	.162	5/16"	3-1/2	1.08	.47	.31	.84
RB723	1000	18-14	.162	5/16"	3-1/2	1.08	.47	.31	.84
RB14-38	100	18-14	.162	3/8"	3-1/2	1.17	.53	.35	.87
RB733	1000	18-14	.162	3/8"	3-1/2	1.17	.53	.35	.87
RB14-12	100	18-14	.162	1/2"	4	1.25	.72	.50	.90
RB753	1000	18-14	.162	1/2"	4	1.25	.72	.50	.90
RC10-6	50	12-10	.210	#6	3	1.00	.37	.27	.81
RC333	500	12-10	.210	#6	3	1.00	.37	.27	.81
RC10-8	50	12-10	.210	#8	5	1.00	.37	.27	.81
RC863	500	12-10	.210	#8	5	1.00	.37	.27	.81
RC10-10	50	12-10	.210	#10	5	1.00	.37	.27	.81
RC363	500	12-10	.210	#10	5	1.00	.37	.27	.81
RC10-14	50	12-10	.210	1/4"	6	1.12	.53	.32	.86
RC713	500	12-10	.210	1/4"	6	1.12	.53	.32	.86
RC10-516	50	12-10	.210	5/16"	6	1.21	.53	.31	.94
RC703	500	12-10	.210	5/16"	6	1.21	.53	.31	.94
RC10-38	50	12-10	.210	3/8"	6	1.27	.59	.35	.98
RC733	500	12-10	.210	3/8"	6	1.27	.59	.35	.98
RC10-12	50	12-10	.210	1/2"	6	1.37	.72	.52	1.02
RC753	500	12-10	.210	1/2"	6	1.37	.72	.52	1.02

\* Not Listed By U.L. CSA  
 \*\* CSA Listed only  
 U.L. Listed E9809

Installing tools: WT2000, WT112M, WT145C, ERG-2001, ERG-2003, WT145A  
 Installing tool: WT1452 (RZ series only)

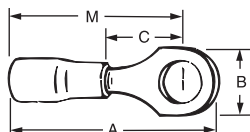



*Catalog numbers with the suffix X indicate an expanded insulation grip. This means a wider wire entry to accommodate heavy wall insulation. Ring terminals won't fall free even if the mounting screw loosens.*

**RB stock thickness: .03**  
**RC stock thickness: .04**

*Most standard bulk catalog numbers can be put on Mylar Tape for reel fed applications (i.e. 12050 tool and application dies). See pages 190-191.*

*Please put the suffix M for Mylar Tape RA2573M. (Bulk number 1000 and 500 packages.)*

### Nylon Insulated Ring – Expanded Insulation Grip

Cat. No.	Pkg. Qty.	Wire Range	Max. Ins.	Bolt Hole	Wt./Lbs. Per 1000	Dimensions			
						A	B	C	M
RB14-4X	100	18-14	.190	#4	4	.80	.26	.14	.67
RB1324	1000	18-14	.190	#4	4	.80	.26	.14	.67
RB14-6X	100	18-14	.190	#6	4	.95	.31	.25	.79
RB854	1000	18-14	.190	#6	4	.95	.31	.25	.79
RB14-8X	100	18-14	.190	#8	5	.95	.31	.25	.79
RB864	1000	18-14	.190	#8	5	.95	.31	.25	.79
RB14-10X	100	18-14	.190	#10	5	.95	.31	.25	.79
RB874	1000	18-14	.190	#10	5	.95	.31	.25	.79
RB14-14X	100	18-14	.190	1/4"	6	1.16	.47	.31	.92
RB714	1000	18-14	.190	1/4"	6	1.16	.47	.31	.92
RB14-516X	100	18-14	.190	5/16"	6	1.16	.47	.31	.92
RB724	1000	18-14	.190	5/16"	6	1.16	.47	.31	.92
RB14-38X	100	18-14	.190	3/8"	6	1.25	.53	.42	.95
RB734	1000	18-14	.190	3/8"	6	1.25	.53	.42	.95
RC10-6X	50	12-10	.250	#6	5	1.10	.37	.27	.91
RC334	500	12-10	.250	#6	5	1.10	.37	.27	.91
RC10-8X	50	12-10	.250	#8	5	1.10	.37	.27	.91
RC864	500	12-10	.250	#8	5	1.10	.37	.27	.91
RC10-10X	50	12-10	.250	#10	5	1.10	.37	.27	.91
RC364	500	12-10	.250	#10	5	1.10	.37	.27	.91
RC10-14X	50	12-10	.250	1/4"	6	1.22	.53	.32	.96
RC714	500	12-10	.250	1/4"	6	1.22	.53	.32	.96
RC10-516X	50	12-10	.250	5/16"	6	1.32	.53	.31	1.05
RC704	500	12-10	.250	5/16"	6	1.32	.53	.31	1.05
RC10-38X	50	12-10	.250	3/8"	6	1.38	.59	.48	1.09
RC734	500	12-10	.250	3/8"	6	1.38	.59	.48	1.09
RC10-12X	50	12-10	.250	1/2"	6	1.48	.72	.52	1.13

U.L. Listed E9809

Installing tools: WT2000, WT112M, WT145C, ERG-2001, ERG-2003, WT145A

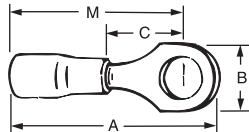



*These ring terminals are self-insulated with heat shrinkable polyolefin and internally coated sealant. Upon completed installation, a fully sealed connection is achieved to protect the joint against the degrading effects of galvanic action, corrosion, and environmental exposure.*

**RAS & RBS stock thickness: .03**  
**RCS stock thickness: .04**

### Heat Shrinkable Ring Terminals – Expanded Insulation Support

Cat. No.	Pkg. Qty.	Wire Range	Max. Ins.	Bolt Hole	Wt./Lbs. Per 1000	Dimensions			
						A	B	C	M
<b>RAS18-6X</b>	100	22-18	.170	#6	2	1.23	.25	.27	1.10
<b>RAS18-8X</b>	100	22-18	.170	#8	3	1.26	.31	.27	1.10
<b>RAS18-10X</b>	100	22-18	.170	#10	2	1.26	.31	.27	1.10
<b>RBS14-6X</b>	100	16-14	.200	#6	3	1.23	.25	.27	1.10
<b>RBS14-8X</b>	100	16-14	.200	#8	3	1.23	.25	.27	1.10
<b>RBS14-10X</b>	100	16-14	.200	#10	3-1/2	1.26	.31	.27	1.10
<b>RCS10-6X</b>	50	12-10	.250	#6	3	1.34	.31	.27	1.15
<b>RCS10-8X</b>	50	12-10	.250	#8	5	1.34	.37	.27	1.15
<b>RCS10-10X</b>	50	12-10	.250	#10	5	1.34	.37	.27	1.15
<b>RCS10-14X</b>	50	12-10	.250	1/4"	6	1.34	.49	.32	1.15

U.L. Listed E9809

Installing tool: WT1255

Note: Not available on Mylar Tape.

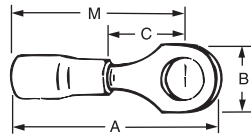

# Sta-Kon<sup>®</sup>

## Terminals



*\* (Chamfered Funnel)*

**RD, RE, RF stock thickness: .04**  
**RG stock thickness: .05\***

### Nylon Insulated Ring

Cat. No.	Pkg. Qty.	Wire Range	Max. Ins.	Bolt Hole	Wt./Lbs. Per 1000	Dimensions			
						A	B	C	M
*RD167	200	8	.340	#8	12	1.48	.42	.28	1.29
*RD8-10	25	8	.340	#10	12	1.48	.42	.28	1.29
*RD367	200	8	.340	#10	12	1.48	.42	.28	1.29
*RD8-14	25	8	.340	1/4"	12	1.54	.46	.36	1.32
*RD717	200	8	.340	1/4"	12	1.54	.46	.36	1.32
*RD8-516	25	8	.340	5/16"	12	1.63	.57	.36	1.35
*RD727	200	8	.340	5/16"	12	1.63	.57	.36	1.35
*RD8-38	25	8	.340	3/8"	12	1.63	.57	.36	1.35
*RD737	200	8	.340	3/8"	12	1.63	.57	.36	1.35
*RD8-12	25	8	.310	1/2"	12	1.79	.82	.55	1.39
*RD757*	200	8	.310	1/2"	12	1.79	.82	.55	1.39
RD10161	200	8AN	.270	#8	12	1.40	.41	.24	1.20
RD10361	200	8AN	.270	#10	12	1.40	.41	.24	1.20
RD10711	200	8AN	.270	1/4"	12	1.45	.45	.34	1.22
RD10721	200	8AN	.270	5/16"	12	1.53	.56	.34	1.25
RD10731	200	8AN	.270	3/8"	12	1.53	.56	.34	1.25
*RE6-10	20	6	.420	#10	16	1.65	.49	.28	1.40
*RE267	200	6	.420	#10	16	1.65	.49	.28	1.40
*RE6-14	20	6	.420	1/4"	16	1.65	.49	.28	1.40
*RE717	200	6	.420	1/4"	16	1.65	.49	.28	1.40
*RE6-516	20	6	.420	5/16"	16	1.76	.61	.34	1.47
*RE727	200	6	.420	5/16"	16	1.76	.61	.34	1.47
*RE6-38	20	6	.420	3/8"	16	1.76	.61	.34	1.47
*RE737	200	6	.420	3/8"	16	1.76	.61	.34	1.47
*RE6-12	20	6	.395	1/2"	16	1.83	.82	.55	1.43
*RE757*	200	6	.395	1/2"	16	1.83	.82	.55	1.43
RE10261	200	6AN	.315	#10	16	1.55	.49	.24	1.31
RE10711	200	6AN	.315	1/4"	16	1.55	.49	.27	1.31
RE10721	200	6AN	.315	5/16"	16	1.70	.60	.34	1.40
RE10731	200	6AN	.315	3/8"	16	1.70	.60	.34	1.40
*RF4-10	15	4	.510	#10	21	1.76	.56	.36	1.49
*RF267	100	4	.510	#10	21	1.76	.56	.36	1.49
*RF4-14	15	4	.510	1/4"	21	1.76	.56	.36	1.49
*RF717	100	4	.510	1/4"	21	1.76	.56	.36	1.49
*RF4-516	15	4	.510	5/16"	21	1.84	.62	.35	1.53
*RF727	100	4	.510	5/16"	21	1.84	.62	.35	1.53
*RF4-38	15	4	.510	3/8"	23	1.84	.62	.35	1.53
*RF737	100	4	.510	3/8"	23	1.84	.62	.35	1.53
*RF757*	100	4	.500	1/2"	23	1.90	.82	.55	1.49
RF10261	100	4AN	.380	#10	26	1.78	.55	.30	1.51
RF10711	100	4AN	.380	1/4"	26	1.78	.55	.30	1.51
RF10721	100	4AN	.380	5/16"	26	1.80	.62	.34	1.49
RF10731	100	4AN	.380	3/8"	26	1.80	.62	.34	1.49
*RG2-10	10	2	.588	#10	42	2.15	.69	.40	1.83
*RG267	50	2	.588	#10	42	2.15	.69	.40	1.83
*RG2-14	10	2	.588	1/4"	42	2.15	.69	.40	1.83
*RG717	50	2	.588	1/4"	42	2.15	.69	.40	1.83
*RG2-516	10	2	.588	5/16"	42	2.15	.69	.40	1.83
*RG727	50	2	.588	5/16"	42	2.15	.69	.40	1.83
*RG2-38	10	2	.588	3/8"	42	2.15	.69	.40	1.83
*RG737	50	2	.588	3/8"	42	2.15	.69	.40	1.83
*RG2-12	10	2	.588	1/2"	42	2.35	.80	.49	1.93
*RG757	50	2	.588	1/2"	42	2.35	.80	.49	1.93
RG9711	50	2AN	.453	1/4"	48	2.07	.69	.40	1.74
RG9731	50	2AN	.453	3/8"	48	2.07	.69	.40	1.74
RG9751	100	2AN	.453	1/2"	48	2.26	.80	.49	1.84

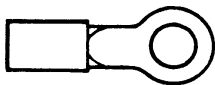

*\*Brazed Seam, Lolly-Pop Style Tongue.*

AN – Aircraft Wire. U.L. Listed E9809. Installing tools: TBM6/TBM6S, ERG-2007, (RD & RE Except Brazed Seam)

Note: Not available on Mylar Tape.

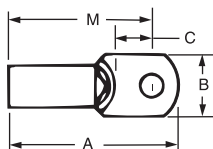



**Stock Thickness:**

- RH = .05
- RJ = .06
- RK = .06
- RL = .07
- RM = .07

**Nylon Insulated Ring – continued**

Cat. No.	Pkg. Qty.	Wire Range	Max. Ins.	Bolt Hole	Wt./Lbs. Per 1000	Dimensions			
						A	B	C	M
RH9711	100	1AN	.500	1/4"	54	2.14	.77	.44	1.81
RH9731	50	1AN	.500	3/8"	54	2.14	.77	.44	1.81
RH9751	100	1AN	.500	1/2"	54	2.34	.77	.54	1.90
RJ9711	50	1/0AN	.550	1/4"	80	2.35	.83	.46	1.97
RJ9731	25	1/0AN	.550	3/8"	80	2.35	.83	.46	1.97
RJ9751	100	1/0AN	.550	1/2"	80	2.49	.89	.55	2.04
RH717	50	1/0	.629	1/4"	80	2.14	.77	.43	1.81
RH727	50	1/0	.629	5/16"	80	2.14	.77	.43	1.81
RH737	50	1/0	.629	3/8"	80	2.14	.77	.43	1.81
RH757	100	1/0	.629	1/2"	80	2.34	.77	.54	1.90
RK9731	25	2/0AN	.610	3/8"	70	2.52	.93	.55	2.14
RK9751	25	2/0AN	.610	1/2"	70	2.60	.93	.55	2.15
RJ717	50	2/0	.675	1/4"	80	2.34	.83	.46	1.96
RJ727	50	2/0	.675	5/16"	80	2.34	.83	.46	1.96
RJ737	50	2/0	.675	3/8"	80	2.34	.83	.46	1.96
RJ757	50	2/0	.675	1/2"	80	2.48	.89	.54	2.03
RL9731	25	3/0AN	.680	3/8"	120	2.83	1.04	.57	2.36
RL9751	100	3/0AN	.680	1/2"	120	2.83	1.04	.57	2.36
RK717	25	3/0	.765	1/4"	84	2.60	.93	.54	2.21
RK727	25	3/0	.765	5/16"	84	2.60	.93	.54	2.21
RK737	25	3/0	.765	3/8"	84	2.60	.93	.54	2.21
RM9731	100	4/0AN	.750	3/8"	160	3.00	1.13	.66	2.51
RM9751	20	4/0AN	.750	1/2"	160	3.00	1.13	.66	2.51
RL737	25	4/0	.785	3/8"	130	2.83	1.04	.57	2.35
RL757	100	4/0	.785	1/2"	130	2.83	1.04	.57	2.35
RM737	25	250MCM	.868	3/8"	130	3.00	1.13	.65	2.51
RM747	25	250MCM	.868	7/16"	130	3.00	1.13	.65	2.51
RM757	25	250MCM	.868	1/2"	130	3.00	1.13	.65	2.51

AN – Aircraft Wire

U.L. Listed E9809

Installing tools: TBM6/TBM6S, ERG-2007, (RD & RE Except Brazed Seam)

Note: Not available on Mylar Tape.

