

TO-3 Metal Can Package

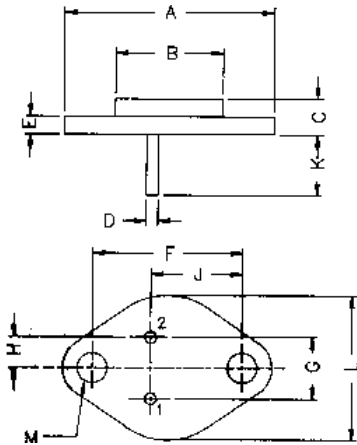

DIM	MIN	MAX
A	—	39,37
B	—	22,22
C	6,35	8,50
D	0,96	1,09
E	—	1,77
F	29,90	30,4
G	10,69	11,18
H	5,20	5,72
J	16,64	17,15
K	11,15	12,25
L	—	26,67
M	3,84	4,19

All dimensions are in mm.

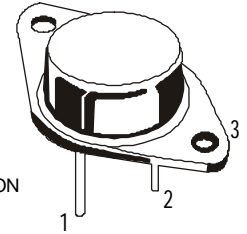

PIN CONFIGURATION
 1. BASE
 2. EMITTER
 3. COLLECTOR

TO-3 Power Package Transistors (NPN)

Type No.	Maximum Ratings					Electrical Characteristics (Ta=25°C, Unless Otherwise Specified)														
	V _{CB0} (V) Mh	V _{CEO} (V) Mh	V _{EBO} (V) Mh	P _D (W) @Tc=25°C	I _C (A)	I _{CB0} (μA) Max	V _{CB} @ (V)	I _{CES} (μA) Max	V _{CE} @ (V)	h _{FE} @ Mh	h _{FE} @ Max	I _C & V _{CE} (A) (V)	V _{CE(SAT)} (V) & Mh	V _{CE(SAT)} (V) Max	I _C @ (A)	C _{ob} (pF) Max	f _t (MHz) Mh	f _t (MHz) Typ	f _t (MHz) Max	I _C (mA)
2N3055	100	60	7	117	15			*1000	100	20	70	4	4	1.1	4		2.5			500
2N3055HV	100	100	7	90	15			*1000	100	20	100	4	4	1.1	4		2.5			500
2N3773	160	140	7	150	16	2000	140			15	60	8	4	1.4	8					
2N4347	140	120	7	100	5			*2000	125	15	60	2	4	1	2					500
2N6253	50	45	7	115	15			*2000	55	20	70	3	4	1.0	3					
2N6257	50	40	5	150	20	4000	50			15	75	8	4	1.5	8		200			1000
2N6371	50	40	7	117	15					15	60	8	4	1.5	8		800			1000
2N6371HV	100	100	5	90	15			*2000	45	15	60	8	4	1.5	8	330	2.5			500
BDY20	60	60	7	120	15					20	70	4	4	3	15		1			1000
BDY38	50	40	7	115	6	1000	50	1000	50	30		2	4	0.7	2		1			
BDY55	100	60	7	117	15			\$5000	100	30	70	0.2	4	1.1	4		10			1000
BDY73	60	60	7	115	15					20	70	4	4	2.5	10					
BU109	330	150	6	60	7			5000	330	100	200			1	1.2	5	10			500

*NOTE: I_{CEX}

TO-3 Power Package Transistors (NPN)

Type No.	Maximum Ratings								Electrical Characteristics (Ta=25°C, Unless Otherwise Specified)										
	V _{CBO} (V) Min	V _{CEO} (V) Min	V _{EBO} (V) Min	P _D (W) @T _C =25°C	I _C (A)	I _{CBO} (μA) Max	V _{CB} @ (V)	I _{CES} (μA) Max	V _{CE} @ (V)	h _{FE} Min	@ Max	I _C & V _{CE} (A) (V)	V _{CE(SAT)} (V) & Max	V _{BE(SAT)} (V) Max	I _C @ (A)	C _{ob} (pF) Max	f _i (MHz) Min	@ Typ	I _C (mA) Max
BU326	# 800	375	10	75	6			1000	800	**	25	1 5	1.5 3	1.4 1.6	2.5 4		6		200
BU326A	# 900	400	10	75	6			1000	900	**	25	1 5	1.5 3	1.4 1.6	2.5 4		6		200
BU608	400	200	6	90	7	100	330	\$5000	400				1.0	1.5	6	10		500	
CDN055	50	50	5	50	5	200	50			25	100	2 2	1		2				
CSC1454	300	300	6	50	4	1000	300			20		1 5	1.5 3	1.4 1.6	2.5 4				
CSD200	1500	700	5	10	2.5	1000	1500	1000	1500	2.5		2 5	5	1.5	2				
CSD1168	1500	400	6	50	5			1000	1500	9	25	1 4	1	1.5	2				
CSD1168P	1500	800	5	50	5			1000	1500	9	18	1 4	1	1.5	2				
CSD1168Q	1500	800	5	50	5			1000	1500	15	25	1 4	1	1.5	2				

#NOTE: V_{CE(S)}
 **: Typical Value
 \$: I_{CEV}

TO-3 Power Package Transistors (PNP)

Type No.	Maximum Ratings								Electrical Characteristics (Ta=25°C, Unless Otherwise Specified)										
	V _{CBO} (V) Min	V _{CEO} (V) Min	V _{EBO} (V) Min	P _D (W) @T _C =25°C	I _C (A)	I _{CBO} (μA) Max	V _{CB} @ (V)	I _{CES} (μA) Max	V _{CE} @ (V)	h _{FE} Min	@ Max	I _C & V _{CE} (A) (V)	V _{CE(SAT)} (V) & Max	V _{BE(SAT)} (V) Max	I _C @ (A)	C _{ob} (pF) Max	f _i (MHz) Min	@ Typ	I _C (mA) Max
BDX18	100	60	7	117	15			*5000	90	20	70	4 4	1.1		15		4.0		1000
CDP055	50	50	5	50	10	200	50			25	100	2 2	1		2				
MJ2955	100	60	7	117	15			*1000	100	20	70	4 4 5	1.1 3		4 10		2.5		500

*NOTE: I_{CEX}