

TECHNICAL DATA
DATA SHEET 128, REV. A.1

AVAILABLE AS

JAN
JANTX
JANTXV
JAN EQUIVALENT* :
SJ36XX*
SX36XX*
SV36XX*

Standard Recovery Rectifiers

Qualified per MIL-PRF-19500/228

DESCRIPTION:

This voidless hermetically sealed standard recovery rectifier diode series is military qualified per MIL-PRF-19500/228 and is targeted for space, commercial and military aircraft, military vehicles, shipboard markets and all high reliability applications.

FEATURES / BENEFITS:

- ✓ Hermetic, non-cavity glass package
- ✓ Category I Metallurgically bonded
- ✓ JAN/ JANTX/ JANTXV available per MIL-PRF-19500/228

MAXIMUM RATINGS

- ✓ Operating and Storage Temperature: -65°C to +175°C
- ✓ Thermal Resistance: 38°C (junction to lead)
- ✓ Forward surge current: 30A @ 8.3 ms half-sine

ELECTRICAL CHARACTERISTICS

TYPE NUMBER	PEAK INVERSE VOLTAGE	AVG RECTIFIED CURRENT	MAXIMUM REVERSE CURRENT @ PIV		MAX. PEAK FORWARD VOLTAGE (PULSED) V _F @ 1A	MAXIMUM SURGE CURRENT ¹ I _{FSM}	MAXIMUM REVERSE RECOVERY TIME ² T _{rr}
		Amps	25°C	150°C			
	Volts	55°C	25°C	150°C	V	Amps	nsec
1N3611	200	1.0	1.0	300	1.1	30	5000
1N3612	400						
1N3613	600						
1N3614	800						
1N3957	1000						

Note 1: I_o = 1A, 8ms surge

Note 2: I_F=0.5A, I_{RM}=1A, I_{r(REC)}=.250A

*Sensitron equivalent diodes are manufactured and screened to MIL-PRF-19500 flow and guidelines starting from wafer fabrication through assembly and testing using our internal specification.

**TECHNICAL DATA
DATA SHEET 128, REV. A.1**

GRAPHS

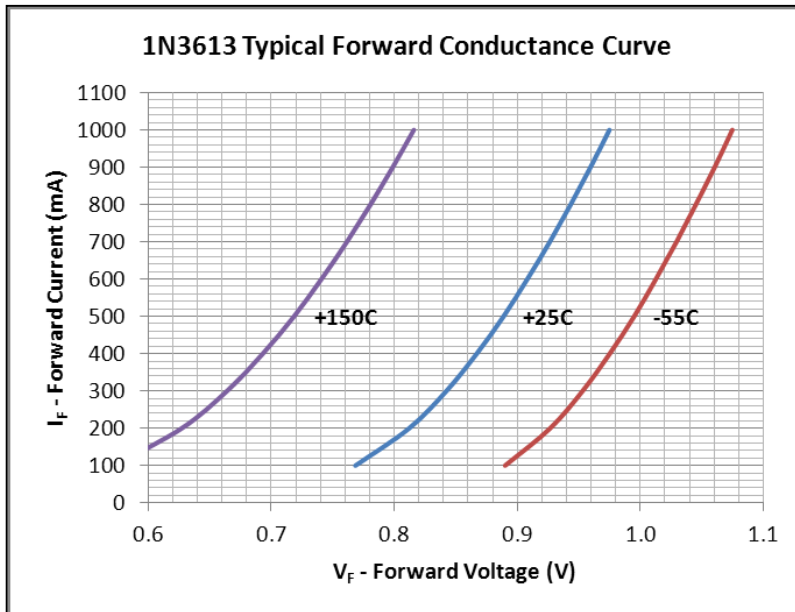

PACKAGE DIMENSIONS (inches/mm)

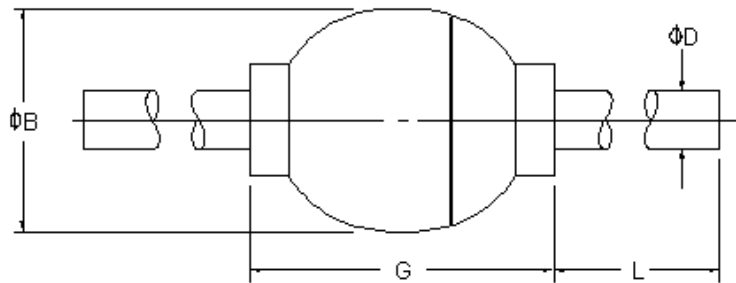

PACKAGE STYLE	DIMENSIONS - INCHES / MILLIMETERS			
	ϕB	ϕD	G	L
101	.060/.110 1.52/2.79	.025/.034 .64/.86	.140/.205 3.56/5.21	.60/1.50 15.2/38.1

PKG. 101

Note: The cathode side is marked with a dark colored band on the diode body.

**TECHNICAL DATA
DATA SHEET 128, REV. A.1**

PART ORDERING INFORMATION

The following part numbers can be screened and tested to the military screening flow. The parts are marked in accordance with the testing performed, example:

Sensitron Screening Level	*Part Number-- Leaded Package (example for 1N3611)
1N	1N3611
JAN	JAN1N3611
SJ	SJ3611
JANTX	JANTX1N3611
SX	SX3611
JANTXV	JANTXV1N3611
SV	SV3611

*Parts can also be ordered Tape & Reel

DISCLAIMER:

- 1- The information given herein, including the specifications and dimensions, is subject to change without prior notice to improve product characteristics. Before ordering, purchasers are advised to contact the Sensitron Semiconductor sales department for the latest version of the datasheet(s).
- 2- In cases where extremely high reliability is required (such as use in nuclear power control, aerospace and aviation, traffic equipment, medical equipment, and safety equipment), safety should be ensured by using semiconductor devices that feature assured safety or by means of users' fail-safe precautions or other arrangement.
- 3- In no event shall Sensitron Semiconductor be liable for any damages that may result from an accident or any other cause during operation of the user's units according to the datasheet(s). Sensitron Semiconductor assumes no responsibility for any intellectual property claims or any other problems that may result from applications of information, products or circuits described in the datasheets.
- 4- In no event shall Sensitron Semiconductor be liable for any failure in a semiconductor device or any secondary damage resulting from use at a value exceeding the absolute maximum rating.
- 5- No license is granted by the datasheet(s) under any patents or other rights of any third party or Sensitron Semiconductor.
- 6- The datasheet(s) may not be reproduced or duplicated, in any form, in whole or part, without the expressed written permission of Sensitron Semiconductor.
- 7- The products (technologies) described in the datasheet(s) are not to be provided to any party whose purpose in their application will hinder maintenance of international peace and safety nor are they to be applied to that purpose by their direct purchasers or any third party. When exporting these products (technologies), the necessary procedures are to be taken in accordance with related laws and regulations.