

TABLE 1
TERMINAL SPECIFICATION K

LEAD STYLE	SOCKET	"L" REF
-2	SC-1P1-XX	.300
-3	SC-1S1-XX	.203
-10	SC-3P1-XX	.230
-11	SC-4P1-XX	.240
-12	SC-5P1-XX	.190
-15	SC-1M2-XX	.167
-18	SC-6P1-XX	.353
-19	SC-8P1-XX	.165
-22	EZ-1P1-XX	.300
-23	EZ-1S1-XX	.203
-30	EZ-3P1-XX	.230
-31	EZ-4P1-XX	.240
-32	EZ-5P1-XX	.190
-38	EZ-6P1-XX	.353

DIMENSIONS ARE IN INCHES		UNLESS OTHERWISE NOTED	TOLERANCES ARE:	TITLE:	DWG NO:
ONE PLACE DECIMALS: ±	THREE PLACE DECIMALS: ±		ANGLES ±	HLS ASSEMBLY	HLS-XXXX-XX-XX-X
TWO PLACE DECIMALS: ±	FOUR PLACE DECIMALS: ±				SHEET 1 OF 1

HLS-XXXX-XX-XX-X

ROW SPECIFICATION
(SEE FIG. 1)
EXPRESSED IN NO. OF ROWS
1 THRU 20

BODY LENGTH SPECIFICATION
(SEE FIG. 1)
EXPRESSED IN NO. OF POS. PER ROW
1 THRU 20

OPTION
-L LOCKING LEAD
(USE ONLY WITH LEAD
STYLE -2 OR -22)

LEAD STYLE SPECIFICATION
(SEE TABLE 1)

PLATING SPECIFICATION
-G: GOLD, SPECIFY -GG IN SOCKET SUFFIX -XX
-T: TIN, SPECIFY -GT IN SOCKET SUFFIX -XX
-TT: TIN/TIN, SPECIFY -TT IN SOCKET SUFFIX -XX
(STYLE 2,10,11,12,18,22,30,31,&32 ONLY)
-S: SELECTIVE, SPECIFY -ST IN SOCKET SUFFIX -XX
(STYLE -2 & -22 ONLY)

ASSEMBLY INSTRUCTIONS

STYLES
-11,12,15,19,31 & 32

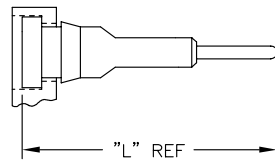

SOCKETS TO BE RECESSED (COUNTER-SUNK)
INTO BODY TO ALLOW BARB
PROTRUSION AT BOTTOM

-L OPTION

AVAILABLE IN STYLES -2 & -22 ONLY

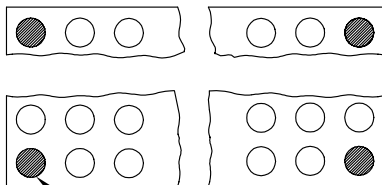

REPLACE CORNER POSITIONS WITH
SC-1L1-XX (WHEN USING SC LEAD STYLE)
OR EZ-1L1-XX (WHEN USING EZ LEAD STYLE)
NOTE: FOR -ST PLATING SPEC.
USE SC-1L1-GT OR EZ-1L1-GT

NOTES:

- 1.) FILL ALL POSITIONS.
- 2.) PINS TO ENTER BODY FROM C'BORE SIDE.
- 3.) BARB ON SOCKET MUST BE VISABLE BELOW BODY.
- 4.) HLS-316-X-22-L TO BE PACKAGED IN
PT-1-24-01-27 USING 2 TP-03.

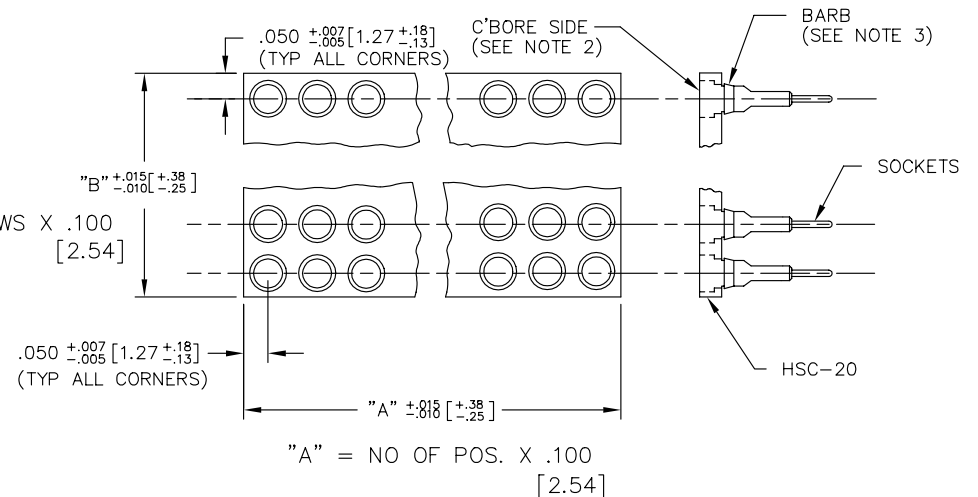

FIGURE 1

PROPRIETARY NOTE
THIS DOCUMENT CONTAINS INFORMATION
CONFIDENTIAL AND PROPRIETARY TO
SAMTEC INC. AND SHALL NOT BE
REPRODUCED OR TRANSFERRED TO
OTHER DOCUMENTS OR DISCLOSED TO
OTHERS OR USED FOR ANY PURPOSE
OTHER THAN THAT FOR WHICH IT WAS
OBTAINED WITHOUT THE EXPRESSED
WRITTEN CONSENT OF SAMTEC INC.

samtec		EXISPROD\ASSEMBLY\100 HLS-ASM
520 PARK EAST BLVD. NEW ALBANY, INDIANA 47150 PHONE (812) 944-6733 P.O. BOX 1147 CODE 55322		
MADE BY: JORDAN 5-30-85	ENGINEER APPROVAL BET 6-4-85	HLS-XXXX-XX-XX-X SHEET 1 OF 1
CHECKED BY: THRUSTON 6-4-85		