



**SERIES 107-70 LATCHING NYLON INSERTER / EXTRACTOR**

**MATERIALS**

**Extractor**

Molded in Glass Filled (30%) 6/6 or Type 6 Nylon. Main handle is UL94-V0, but latch is UL94-V2.

**Assembly Pin**

Stainless steel, passivated

**COLOR**

Series 107-70 standard color is black. Other colors available, please contact an Application Engineer with your requirements.

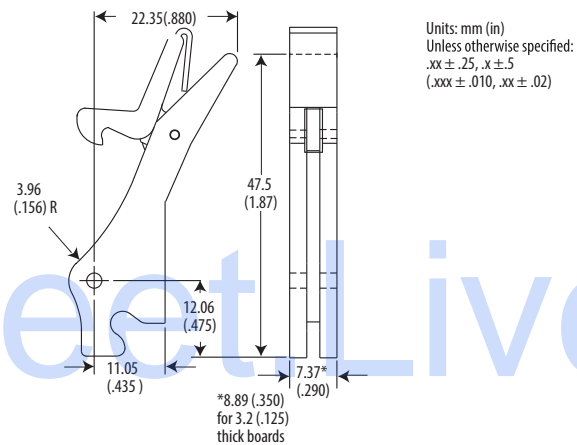

**HOT STAMPING**

Hot stamp marking service is available. Please contact an Application Engineer with your requirements.

**APPLICATION DATA**

Two inserter or inserter-extractors are recommended per printed circuit board taller than 127 (5) in height.

**Detail of Actuating Surfaces**

Required on Top and Bottom guide plates  
Provides insertion and extraction travel of 8.9 (.35) min.

Nominal position of card edge when seated in connector. The inserter-extractor can move the board an additional 1.3 (.050) if necessary due to the tolerances of the assembly

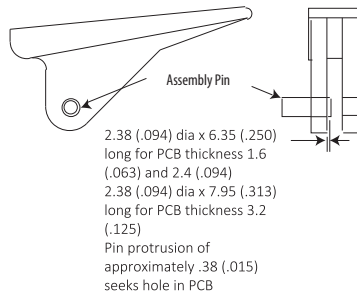
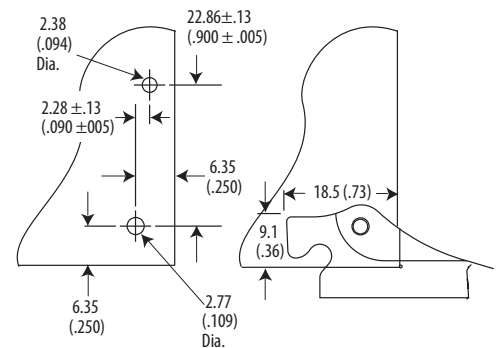
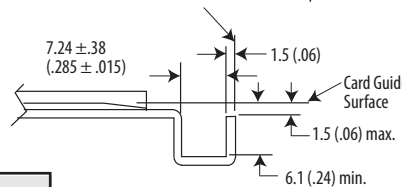

**ASSEMBLY PIN**

Option to be pre-started for:

- Faster and easier installation of the extractor to the PCB
- Eliminates the need for special tools or equipment and set up time.
- Eliminates loss of loose assembly pins

If the "P" option is not selected, the extractors and the pins will be packaged separately.

Part Number Code	
Series 107-70 Inserter/Extractor	P 107-70 - 3
Assembly Pin	
Loose _____ [blank]	
Pre assembled _____ P	
PCB Thickness	
1.6 (.063) _____ [blank]	
2.4 (.094) _____	3
3.2 (.125) _____	4

**Part Number Code example: P107-70-3**

Series 107-70 extractor, with pre-started assembly pin, for PCB thickness of 2.4 (.094)