

APEM switches now offers a NEW expanded range of panel mounting LED indicators. The range has seven different mounting hole sizes, three different bezel styles manufactured from high quality brass and ABS. Both bezel materials are available plated in bright chrome, black chrome, satin chrome and gold. A wide range of terminations are available and IP67 sealing can be achieved as an option. The LEDs are available in five different colors, plus bi-color, tri-color and flashing LEDs. A complementary range of super bright, water clear LEDs are also available. The indicators are available with integral resistors to permit direct connection to 6 V, 12 V, 24 V, 28 V, 110 V, and 220 V systems. Other voltages are available upon request. In addition APEM has designed and developed an extensive range of LED based lamps. Please contact your local Allied sales representative for assistance with APEM's complete line of products.

19 mm Panel Mount LED Indicators

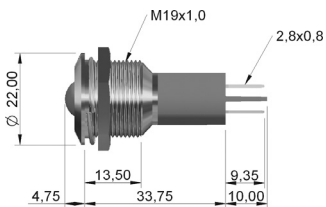

- ▶ 19 mm Mounting Hole
- ▶ 11 mm Maximum Panel Thickness
- ▶ Uses 10 mm Diffused LED
- ▶ Front Mounting
- ▶ Hex Nut and Spring Washer Included
- ▶ IP67 Panel Sealing (EN60529)
- ▶ 2.8 x 0.8 mm Terminals
- ▶ Gold Terminal Denotes Anode Connection

- ▶ 60° Viewing Angle
- ▶ Red/Yellow/Green Indicators Wired Common Cathode
- ▶ Red/Yellow/Green Indicators Generate Yellow When Both Colors Are Illuminated
- ▶ 5 V Maximum Reverse Voltage
- ▶ 100,000 Hours Life Expectancy
- ▶ -40 to 85°C Operating Temperature Range
- ▶ UL Recognized

Black Chrome Finish

Color	Voltage	Prominent Bezel		
		Stock No.	Mfr.'s Type	EACH
Blue	12 VDC	70066280	Q19P1BXXB12E	16.42
Green	12 VDC	70066283	Q19P1BXXG12E	13.36
Red	12 VDC	70066286	Q19P1BXXR12E	13.36
Red/Yellow/Green	12 VDC	70066294	Q19P1BZZRYG12E	14.67
White	12 VDC	70066289	Q19P1BXXW12E	17.46
Yellow	12 VDC	70066292	Q19P1BXXY12E	13.36
Blue	24 VDC	70066281	Q19P1BXXB24E	16.42
Green	24 VDC	70066284	Q19P1BXXG24E	13.36
Red	24 VDC	70066287	Q19P1BXXR24E	13.36
Red/Yellow/Green	24 VDC	70066295	Q19P1BZZRYG24E	14.67
White	24 VDC	70066290	Q19P1BXXW24E	17.46
Yellow	24 VDC	70066293	Q19P1BXXY24E	13.36
Blue	110 VAC	70066279	Q19P1BXXB110E	18.39
Green	110 VAC	70066282	Q19P1BXXG110E	15.34
Red	110 VAC	70066285	Q19P1BXXR110E	15.34
White	110 VAC	70066288	Q19P1BXXW110E	19.44
Yellow	110 VAC	70066291	Q19P1BXXY110E	15.34

Bright Chrome Finish

Color	Voltage	Prominent Bezel		
		Stock No.	Mfr.'s Type	EACH
Blue	12 VDC	70066297	Q19P1CXXB12E	16.42
Green	12 VDC	70066300	Q19P1CXXG12E	13.36
Red	12 VDC	70066303	Q19P1CXXR12E	13.36
Red/Yellow/Green	12 VDC	70066311	Q19P1CZZRYG12E	14.67
White	12 VDC	70066306	Q19P1CXXW12E	17.46
Yellow	12 VDC	70066309	Q19P1CXXY12E	13.36
Blue	24 VDC	70066298	Q19P1CXXB24E	16.42
Green	24 VDC	70066301	Q19P1CXXG24E	13.36
Red	24 VDC	70066304	Q19P1CXXR24E	13.36
Red/Yellow/Green	24 VDC	70066312	Q19P1CZZRYG24E	14.67
White	24 VDC	70066307	Q19P1CXXW24E	17.46
Yellow	24 VDC	70066310	Q19P1CXXY24E	13.36
Blue	110 VAC	70066296	Q19P1CXXB110E	18.39
Green	110 VAC	70066299	Q19P1CXXG110E	15.34
Red	110 VAC	70066302	Q19P1CXXR110E	15.34
White	110 VAC	70066305	Q19P1CXXW110E	19.44
Yellow	110 VAC	70066308	Q19P1CXXY110E	15.34

22 mm Panel Mount LED Indicators

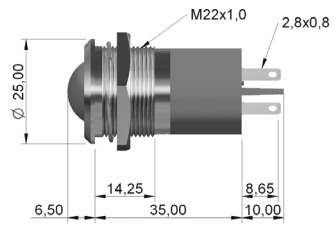
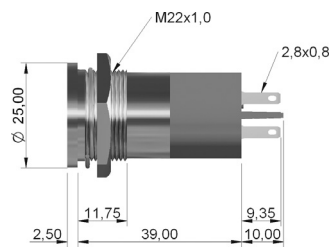

- ▶ 22 mm Mounting Hole
- ▶ Maximum Panel Thickness — 12 mm for Prominent Bezel, 10 mm for Flush Bezel
- ▶ Front Mounting
- ▶ Hex Nut and Spring Washer Included
- ▶ IP67 Panel Sealing (EN60529)
- ▶ 2.8 x 0.8 mm Terminals
- ▶ Gold Terminal Denotes Anode Connection

- ▶ 100° Viewing Angle
- ▶ Red/Yellow/Green Indicators Wired Common Cathode
- ▶ Red/Yellow/Green Indicators Generate Yellow When Both Colors Are Illuminated
- ▶ 5 V Maximum Reverse Voltage
- ▶ 100,000 Hours Life Expectancy
- ▶ -40 to 85°C Operating Temperature Range
- ▶ UL Recognized

Black Chrome Finish

Color	Voltage	Flush Bezel			Prominent Bezel		
		Stock No.	Mfr.'s Type	EACH	Stock No.	Mfr.'s Type	EACH
Green	12 VDC	70066314	Q22F1BXXG12E	18.61	70066338	Q22P1BXXG12E	18.61
Red	12 VDC	70066317	Q22F1BXXR12E	18.61	70066341	Q22P1BXXR12E	18.61
White	12 VDC	70066320	Q22F1BXXW12E	25.95	70066344	Q22P1BXXW12E	25.95
Yellow	12 VDC	70066323	Q22F1BXXY12E	18.61	70066347	Q22P1BXXY12E	18.61
Red/Yellow/Green	12 VDC	—	—	—	70066349	Q22P1BZZRYG12E	21.22
Green	24 VDC	70066315	Q22F1BXXG24E	18.61	70066339	Q22P1BXXG24E	18.61
Red	24 VDC	70066318	Q22F1BXXR24E	18.61	70066342	Q22P1BXXR24E	18.61
White	24 VDC	70066321	Q22F1BXXW24E	25.95	70066345	Q22P1BXXW24E	25.95
Yellow	24 VDC	70066324	Q22F1BXXY24E	18.61	70066348	Q22P1BXXY24E	18.61
Red/Yellow/Green	24 VDC	—	—	—	70066350	Q22P1BZZRYG24E	21.22
Green	110 VAC	70066313	Q22F1BXXG110E	20.58	70066337	Q22P1BXXG110E	20.58
Red	110 VAC	70066316	Q22F1BXXR110E	20.58	70066340	Q22P1BXXR110E	20.58
White	110 VAC	70066319	Q22F1BXXW110E	27.93	70066343	Q22P1BXXW110E	27.93
Yellow	110 VAC	70066322	Q22F1BXXY110E	20.58	70066346	Q22P1BXXY110E	20.58

Bright Chrome Finish

Color	Voltage	Flush Bezel			Prominent Bezel		
		Stock No.	Mfr.'s Type	EACH	Stock No.	Mfr.'s Type	EACH
Green	12 VDC	70066326	Q22F1CXXG12E	18.61	70066352	Q22P1CXXG12E	18.61
Red	12 VDC	70066329	Q22F1CXXR12E	18.61	70066355	Q22P1CXXR12E	18.61
White	12 VDC	70066332	Q22F1CXXW12E	25.95	70066358	Q22P1CXXW12E	25.95
Yellow	12 VDC	70066335	Q22F1CXXY12E	18.61	70066361	Q22P1CXXY12E	18.61
Red/Yellow/Green	12 VDC	—	—	—	70066363	Q22P1CZZRYG12E	21.22
Green	24 VDC	70066327	Q22F1CXXG24E	18.61	70066353	Q22P1CXXG24E	18.61
Red	24 VDC	70066330	Q22F1CXXR24E	18.61	70066356	Q22P1CXXR24E	18.61
Red/Yellow/Green	24 VDC	70066333	Q22F1CXXW24E	25.95	70066364	Q22P1CZZRYG24E	21.22
White	24 VDC	70066336	Q22F1CXXY24E	18.61	70066359	Q22P1CXXW24E	25.95
Yellow	24 VDC	—	—	—	70066362	Q22P1CZZRYG24E	18.61
Green	110 VAC	70066325	Q22F1CXXG110E	20.58	70066351	Q22P1CXXG110E	20.58
Red	110 VAC	70066328	Q22F1CXXR110E	20.58	70066354	Q22P1CXXR110E	20.58
White	110 VAC	70066331	Q22F1CXXW110E	27.93	70066357	Q22P1CXXW110E	27.93
Yellow	110 VAC	70066334	Q22F1CXXY110E	20.58	70066360	Q22P1CXXY110E	20.58