

Tous droits strictement réservés. Reproduction ou communication a des tiers interdite sous quelque forme que ce soit sans autorisation écrite du propriétaire. Propriété de ©BERG ELECTRONICS. Droits de reproduction BERG ELECTRONICS INC.

BERG
ELECTRONICS

All rights strictly reserved. Reproduction or issue to third parties in any form whatever is not permitted without written authority from the proprietor. Property of ©BERG ELECTRONICS Copyright BERG ELECTRONICS INC.

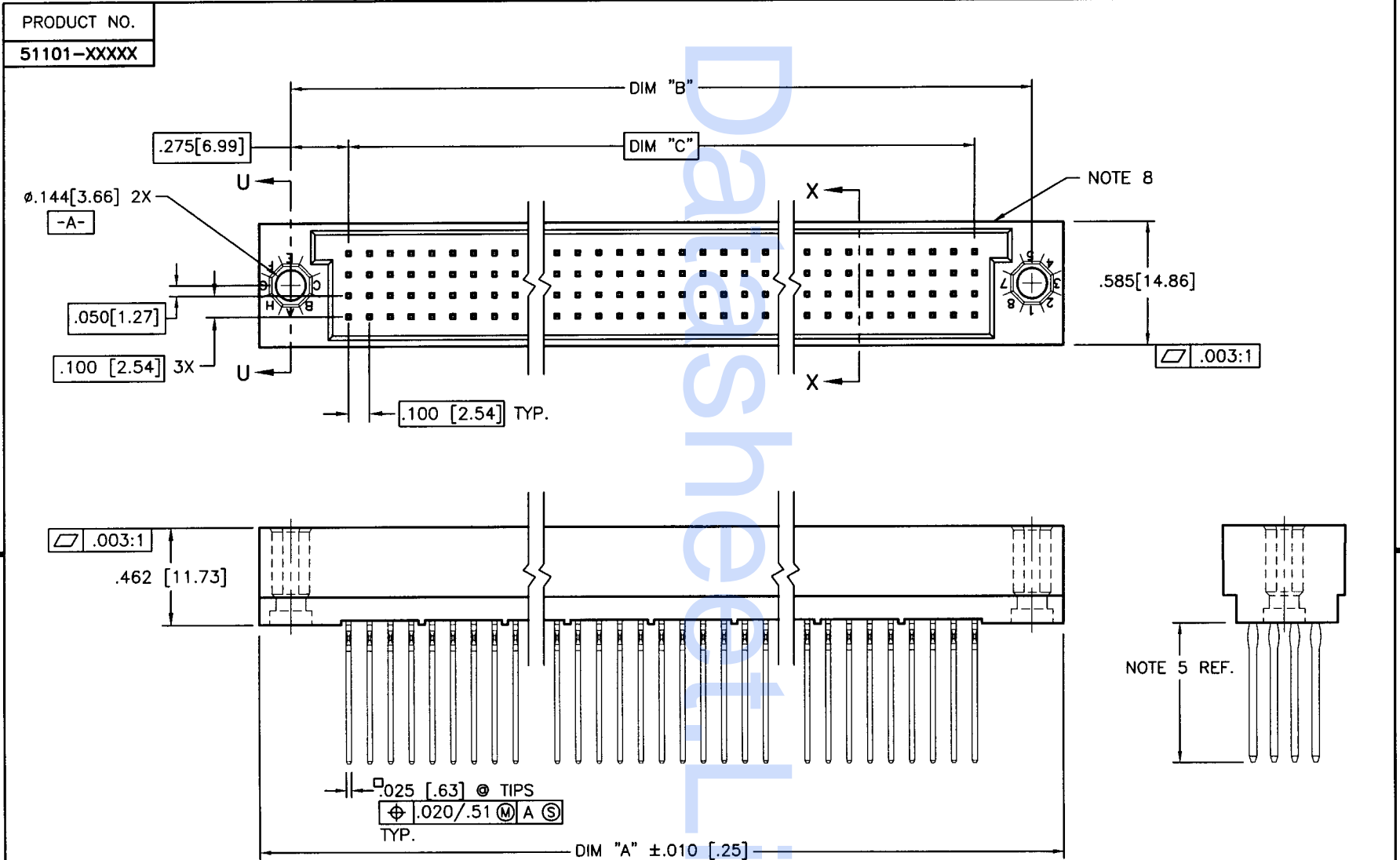

mat'l. code NOTE 3				tolerances unless otherwise specified		CUSTOMER COPY		BERG ELECTRONICS		
ltr	ecn no	dr	date	linear	.XX ±.01/.X±.3	projection ⊕	title 4 ROW, VERTICAL HEADER w/PRESS FIT PINS, 0 G.P.			
A	V71114	MSC	7/31/97		.XXX ±.005/.XX±.13		INCH/MM	product family HPC		code -
					.XXX ±.0020/.XXX±.051			scale 1:1	size dwg no A 51101	
				angles 0° ±2°	dr M.CLOUSER 7/31/97		cage code 22526			
					enr S.CLARK 7/31/97					
					chr S.CLARK 7/31/97					
					appd S.CLARK 7/31/97					
sheet index	revision sheet	A 1	A 2							

Tous droits strictement reserves. Reproduction ou communication a des tiers interdite sous quelque forme que ce soit sans autorisation écrite du propriétaire. Propriete de ©BERG ELECTRONICS. Droits de reproduction BERG ELECTRONICS INC.

All rights strictly reserved. Reproduction or issue to third parties in any form whatever is not permitted without written authority from the proprietor. Property of ©BERG ELECTRONICS Copyright BERG ELECTRONICS INC.

PRODUCT NO.	DIM.	LENGTH FORMULAS
51101-XXXX	DIM "A"	.100/2.54 x NO. OF COLUMNS +.75/19.1
	DIM "B"	.100/2.54 x NO. OF COLUMNS +.450/11.43
	DIM "C"	.100/2.54 x NO. OF COLUMNS -.100/2.54

SECTION U-U

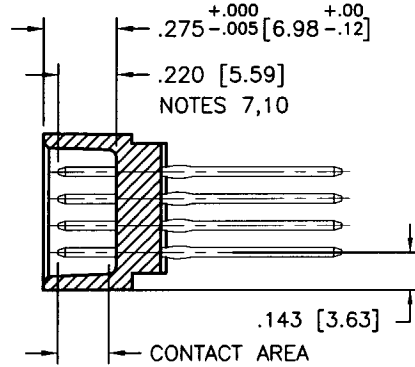
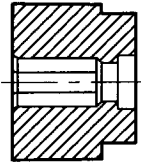

SECTION X-X

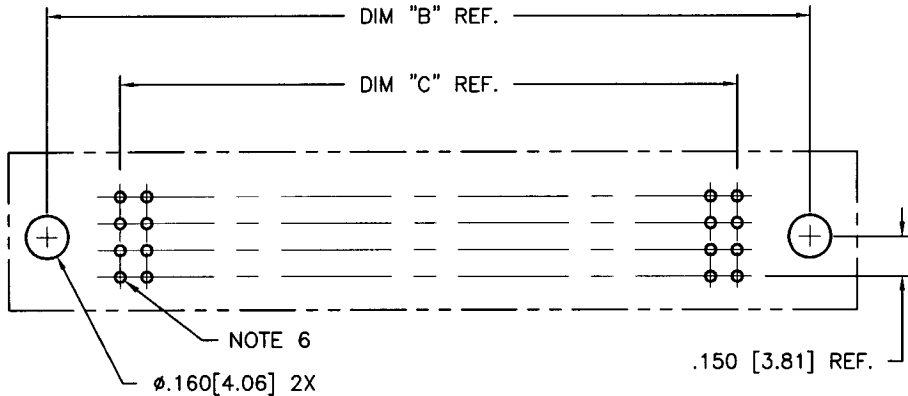

RECOMMENDED PCB LAYOUT
(ALL HOLES LOCATED ON .100/2.54 GRID UNLESS OTHERWISE SPECIFIED)

NOTES:

- PRODUCT NUMBERING CODE:
51101 - X XXX X
TAIL LENGTH(NOTE 5)
NO. OF POSITIONS(NOTE 2)
PLATING(NOTE 4)
BASE NUMBER
- THIS PRODUCT IS CONFIGURED IN SIZES OF 6 thru 80 COLUMNS IN INCREMENTS OF ONE.
i.e.: 6,7,8,9,.....79,80.
- HOUSING MATERIAL: GLASS FILLED PPS.
PIN MATERIAL: PHOS BRONZE
- PLATING CONTACT AREA OPTIONS:
1 = 30u"/.76u GOLD
3 = 50u"/1.27u GOLD
5 = 30u"/.76u GXT
- TAIL LENGTH OPTIONS:(±.015/.38)
A = .177/4.5 P = .470/11.94 .062 PCB/SHROUD
C = .533/13.54 L = .188/4.78 .062 PCB
D = .733/18.62 R = .250/6.35 .062 PCB
G = .250/6.35
- ø.0453/1.151 DRILLED HOLE PLATED WITH .0003/.007 MIN. SnPb OVER .001/.03 to .003/.08 Cu. PLATING TO ACHIEVE A ø.040±.003/1.02±.08 HOLE.
- TO ASSURE PROPER INSTALLATION: BERG TOOLING, AS SPECIFIED IN INSTRUCTION MANUAL 155915-001 MUST BE USED. PIN MATING LENGTH WILL BE ±.002/.05 AFTER INSTALLATION.
- "BERG" NAME, PART NUMBER AND LOT CODE TO APPEAR ON THIS SURFACE PER BUS-12-108.
- FOR DOCUMENTATION MENU, SEE BERG BUS-01-057.
- REFERENCE 50807 FOR F.M.L.B. AVAILABLE OPTIONS AND WORKSHEET.
- MANUFACTURE AS PER BUS-24-004.

mat'l. code				tolerances unless otherwise specified		CUSTOMER COPY		BERG ELECTRONICS	
NOTE 3									
ltr	ecn no	dr	date	linear	.XX ±.01/.X±.3	projection	title		
A					.XXX ±.005/.XX±.13		4 ROW, VERTICAL HEADER		
					.XXX ±.0020/.XXX±.051		w/PRESS FIT PINS, 0 G.P.		
				angles	0° ±2'	INCH/MM	product family	HPC	code
				dr	M.CLOUSER 7/31/97	scale	size	dwg no	sheet
				enr	S.CLARK 7/31/97		A	51101	2 of
				chr	S.CLARK 7/31/97		1:1		
				appd	S.CLARK 7/31/97				
sheet index	revision sheet								